

PROGETTO PON01_02710 – MASSIMO
Monitoraggio in Area Sismica di Sistemi Monumentali



CITTA' DI REGGIO CALABRIA
EX MONASTERO DELLA VISITAZIONE
ANALISI DI DETTAGLIO DEL MANUFATTO
 (OR2)

RILEVIO STRUTTURALE	DATA: 29 NOVEMBRE 2013
ELABORATO:	VERSIONE DEFINITIVA
CARPENTERIA PIANO SEMINTERRATO	TAV. RS/MV-02
CARPENTERIA I LIVELLO	SCALA 1:200



SISMIlab
 Solutions and Innovations for Structural Monitoring

Spin-Off Università della Calabria
 Via Pietro Bucci - 87036 Rende (CS) - ITALY
 Tel.: 0984-447093 --- Fax: 0984-447093
 E-mail: info@sismlab.it --- Internet: www.sismlab.it

Ing. G. PORCO Responsabile Scientifico SISMIlab S.r.l.	Ing. D. ROMANO Responsabile Tecnico SISMIlab S.r.l.
Supporto all'attività di rilievo Ing. F. MORBONE	Supporto all'elaborazione CAD Ing. G.F. MONTERO

CARPENTERIA I LIVELLO
 Scala 1:200

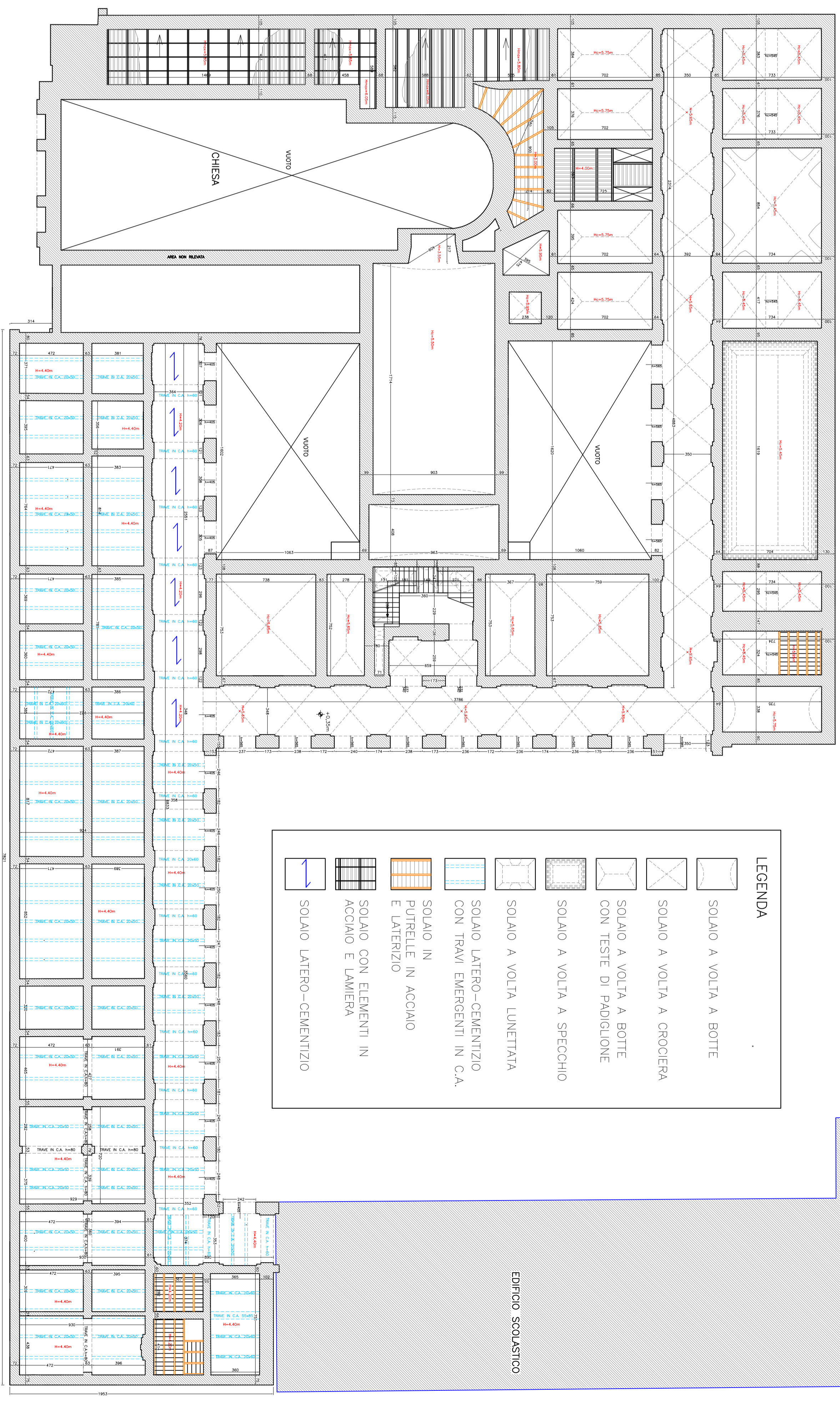
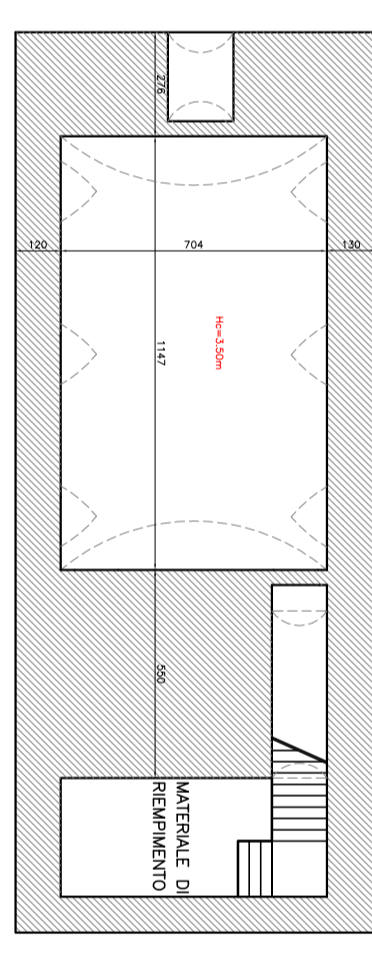
CARPENTERIA PIANO SEMINTERRATO
 Scala 1:200

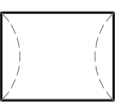
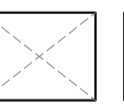
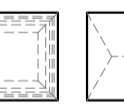
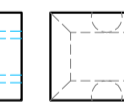
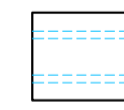
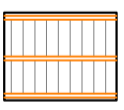
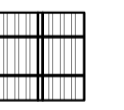

LEGENDA

	SOLAI A VOLTA A BOTTE
	SOLAI A VOLTA A CROCIERA
	SOLAI A VOLTA A BOTTE CON TESTE DI PADIGLIONE
	SOLAI A VOLTA A SPECCHIO
	SOLAI A VOLTA LUNETTATA
	SOLAI LATERO-CEMENTIZIO CON TRAVI EMERGENTI IN C.A.
	SOLAI IN PUTRELLE IN ACCIAIO E LATERIZIO
	SOLAI CON ELEMENTI IN ACCIAIO E LAMIERA
	SOLAI LATERO-CEMENTIZIO

EDIFICIO SCOLASTICO